

INSTRUCTIONS FOR THE FOLLOWING FIXTURES

Order	Model		
R51041	RENO-FCWP-MW-DV-MCCT-R1-BRN	R51045	RENO-FCWP-MW-DV-MCCT-R1-WH
R51042	RENO-FCWP-MW-DV-MCCT-R2-BRN	R51046	RENO-FCWP-MW-DV-MCCT-R2-WH
R51043	RENO-FCWP-MW-DV-MCCT-R1-BK		
R51044	RENO-FCWP-MW-DV-MCCT-R2-BK		

WARNING

PLEASE READ ALL INSTRUCTIONS BEFORE ATTEMPTING INSTALLATION

- To prevent personal injury or product damage only licensed electricians should install.
- To avoid electric shock or component damage disconnect power before attempting installation or servicing.
- Disconnect product and allow cooling prior to servicing.
- Any alteration or modification of this product is forbidden as it may cause personal injury, death, property damage and/or product malfunction.
- To prevent product malfunction and/or electrical shock this product must be properly grounded.
- This luminaire is designed to operate in ambient temperatures ranging from -40°C to 45°C.
- MIN 75°C SUPPLY CONDUCTORS.
- CONSULT A QUALIFIED ELECTRICIAN TO ENSURE CORRECT BRANCH CIRCUIT CONDUCTOR.

INSTALLATION

1. Fix the J-Box on the wall. (Fig 1)

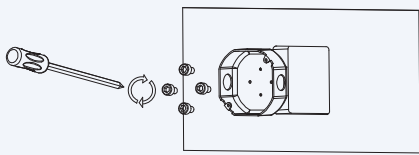

Fig 1

2. Fix the Mounting Plate on the J-Box. (Fig 2)

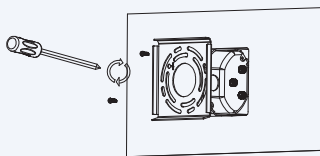

Fig 2

3. Hook the hanging rope of the lamp on the Mounting Plate. (Fig 3)

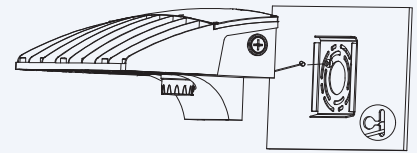

Fig 3

4. Connect the corresponding terminals according to the wiring diagram, connect L, N, and ground wires properly. (Fig 4)

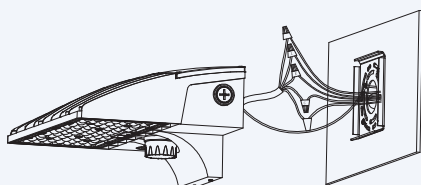
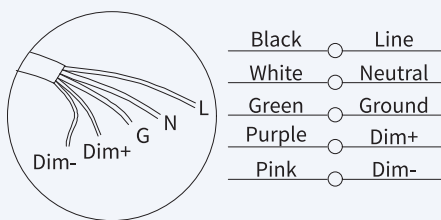

Fig 4

5. Hide the connected wires into the J-Box and hook the lamp body onto the Mounting Plate. (Fig 5)

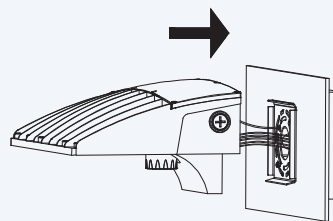

Fig 5

6. Fix the lamp body and the Mounting Plate with screws. (Fig 6)

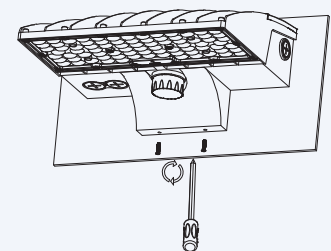

Fig 6

WATTAGE & CCT SELECTABLE GUIDANCE

Factory Default Setting:
Watt: 60W/100W CCT: 5000K Photocell: ON

