

WARNING

PLEASE READ ALL INSTRUCTIONS BEFORE INSTALLATION

Safety: This fixture must be wired in accordance with the national electrical code and applicable local codes and ordinances. Proper grounding is required to insure personal safety. Carefully observe the grounding procedure under installation section. All work should be done by a qualified electrician.

>RISK OF ELECTRIC SHOCK - Disconnect power at fuse or circuit breaker before installing or servicing.

>RISK OF PERSONAL INJURY - Fixture may become damaged and/or unstable if not installed properly. Tighten all fixture components to their recommended torque values.

WARNING: Make certain power is **OFF** before starting installation or attempting any maintenance.

INSTALLATION

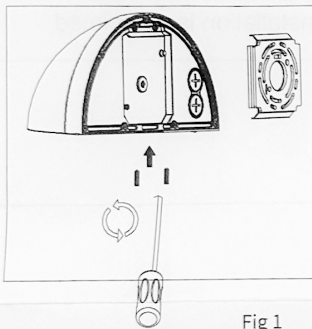

Fig 1

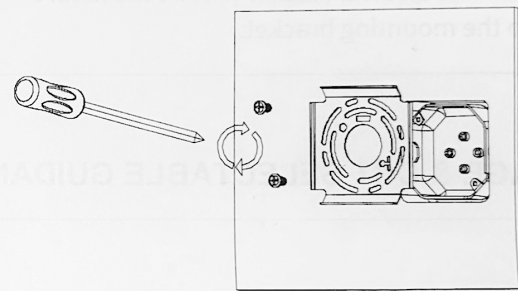

Fig 2

1. Use the Hex Wrench to loose the 2 Allen Screws. And take apart the mounting bracket from the fixture.

2. Install the mounting bracket to the junction box.

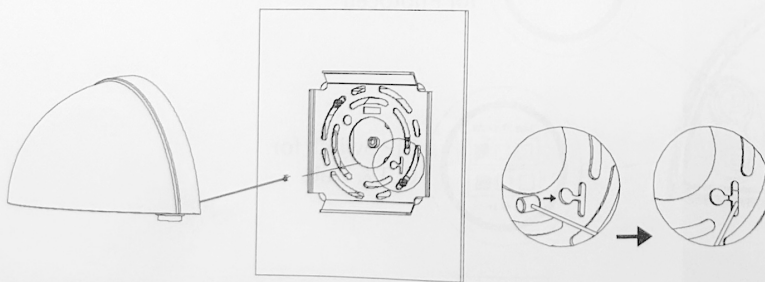

Fig 3

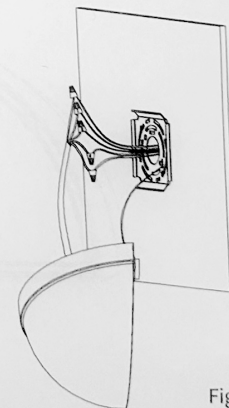
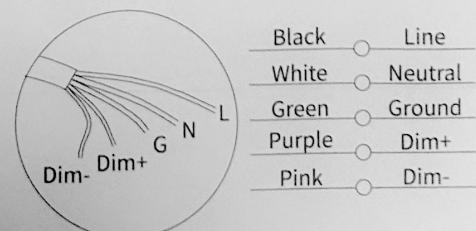

Fig 4

3. Attach the safety cable to the bracket to hold the fixture onto the wall.

4. Connect wires according to below wire diagram.



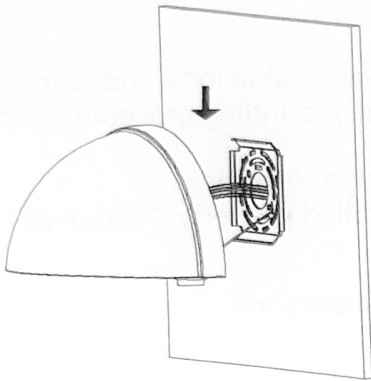

Fig 5

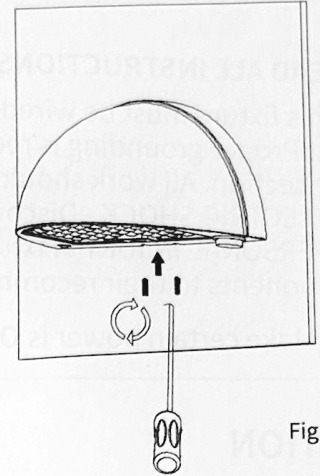
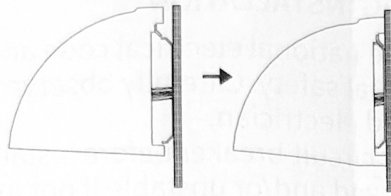

Fig 6

5. Follow the arrow direction to slide the fixture onto the mounting bracket.

6. Tighten the 2 Allen Screws and installation is completed.

WATTAGE & CCT SELECTABLE GUIDANCE

Factory Default Setting:
Watt: 40W/80W CCT: 5000K Photocell: ON

